

RF-A // ROUND TAPERED ALUMINUM

PEDESTRIAN METAL POLE



King Luminaire

POLE SPECIFICATIONS

MATERIAL:
Round Tapered Aluminum

POLE HEIGHT:
10' - 18'

OPTIONS:
GFI - Ground Fault Receptacle
BA - Banner Arms
FPH - Flower Pot Holder
FH - Flag Holder

ALLOY:
5052-H32

FINISH:
Available in textured or smooth.

CROSS SECTION:

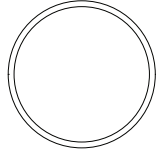

Round Tapered (RF)

BASEPLATE DETAILS

| Pole | | Baseplate | | Bolt Circle | | Anchor Bolts | |
|--------------------|---------------------|-----------------|----------------|--------------|----------|--------------------------|-----------------|
| Butt Diameter (in) | Wall Thickness (in) | "X" Square (in) | Thickness (in) | "Y" Dia (in) | +/- (in) | Dia x Length x Hook (in) | Projection (in) |
| 5.75 | 0.091 | 11.25 | 0.5 | 10 | 1 | 0.75 x 27 x 3.75 | 3 |
| 5.75 | 0.144 | 11.25 | 0.75 | 10 | 1 | 0.75 x 27 x 3.75 | 3.25 |
| 5.75 | 0.182 | 11.25 | 0.75 | 10 | 1 | 0.75 x 27 x 3.75 | 3.25 |
| 5.75 | 0.229 | 11.25 | 0.75 | 10 | 1 | 0.75 x 27 x 3.75 | 3.25 |
| 6.5 | 0.091 | 12.0625 | 0.75 | 11 | 1 | 0.75 x 27 x 3.75 | 3.25 |
| 6.5 | 0.144 | 12.0625 | 0.75 | 11 | 1 | 0.75 x 27 x 3.75 | 3.25 |
| 6.5 | 0.182 | 12.0625 | 0.75 | 11 | 1 | 0.75 x 27 x 3.75 | 3.25 |
| 6.5 | 0.229 | 12.0625 | 0.75 | 11 | 1 | 0.75 x 27 x 3.75 | 3.25 |
| 7 | 0.091 | 12.0625 | 0.75 | 11 | 0.75 | 0.75 x 27 x 3.75 | 3.25 |
| 7 | 0.144 | 12.0625 | 0.75 | 11 | 0.75 | 0.75 x 27 x 3.75 | 3.25 |
| 7 | 0.182 | 12.0625 | 0.75 | 11 | 0.75 | 0.75 x 27 x 3.75 | 3.25 |
| 7 | 0.299 | 12.0625 | 0.75 | 11 | 0.75 | 0.75 x 27 x 3.75 | 3.25 |

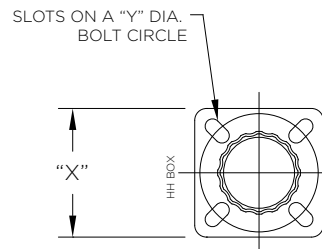

HOW TO ORDER

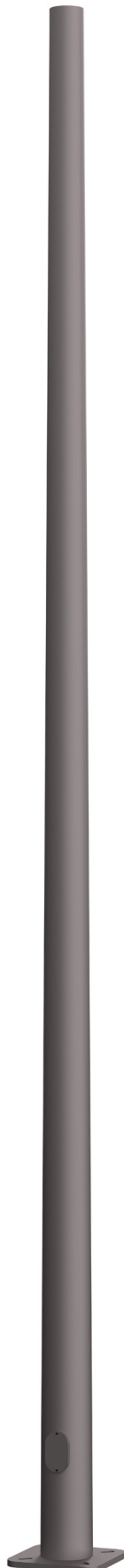
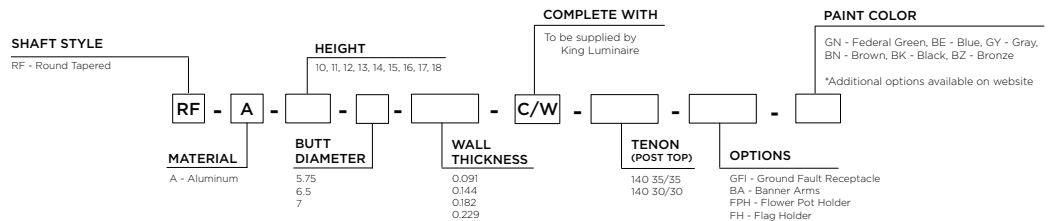

SHAFT DETAILS

RF-A PEDESTRIAN METAL POLE

RF ALUMINUM // Pole Details

| Nominal Mounting Height (ft) | Catalog Code | Alloy | Butt (in) | Tip (in) | Wall Thickness (in) | Handhole | Wt. (lbs) * |
|------------------------------|--------------------|----------|-----------|----------|---------------------|---------------------------------|-------------|
| 10 | RF-A-10-5.75-0.091 | 5052-H32 | 5.75 | 4.35 | 0.091 | 3" x 5" Reinforced (MIN 9" AG) | 24 |
| | RF-A-10-5.75-0.144 | 5052-H32 | 5.75 | 4.35 | 0.144 | 3" x 5" Reinforced (MIN 9" AG) | 37 |
| | RF-A-10-5.75-0.182 | 5052-H32 | 5.75 | 4.35 | 0.182 | 3" x 5" Reinforced (MIN 9" AG) | 43 |
| | RF-A-10-5.75-0.229 | 5052-H32 | 5.75 | 4.35 | 0.229 | 3" x 5" Reinforced (MIN 9" AG) | 52 |
| | RF-A-10-6.5-0.091 | 5052-H32 | 6.5 | 5.1 | 0.091 | 3" x 5" Reinforced (MIN 14" AG) | 31 |
| | RF-A-10-6.5-0.144 | 5052-H32 | 6.5 | 5.1 | 0.144 | 3" x 5" Reinforced (MIN 14" AG) | 42 |
| | RF-A-10-6.5-0.182 | 5052-H32 | 6.5 | 5.1 | 0.182 | 3" x 5" Reinforced (MIN 14" AG) | 50 |
| | RF-A-10-6.5-0.229 | 5052-H32 | 6.5 | 5.1 | 0.229 | 3" x 5" Reinforced (MIN 14" AG) | 60 |
| 11 | RF-A-11-5.75-0.091 | 5052-H32 | 5.75 | 4.21 | 0.091 | 3" x 5" Reinforced (MIN 9" AG) | 25 |
| | RF-A-11-5.75-0.144 | 5052-H32 | 5.75 | 4.21 | 0.144 | 3" x 5" Reinforced (MIN 9" AG) | 39 |
| | RF-A-11-5.75-0.182 | 5052-H32 | 5.75 | 4.21 | 0.182 | 3" x 5" Reinforced (MIN 9" AG) | 46 |
| | RF-A-11-5.75-0.229 | 5052-H32 | 5.75 | 4.21 | 0.229 | 3" x 5" Reinforced (MIN 9" AG) | 55 |
| | RF-A-11-6.5-0.091 | 5052-H32 | 6.5 | 4.96 | 0.091 | 3" x 5" Reinforced (MIN 14" AG) | 33 |
| | RF-A-11-6.5-0.144 | 5052-H32 | 6.5 | 4.96 | 0.144 | 3" x 5" Reinforced (MIN 14" AG) | 45 |
| | RF-A-11-6.5-0.182 | 5052-H32 | 6.5 | 4.96 | 0.182 | 3" x 5" Reinforced (MIN 14" AG) | 53 |
| | RF-A-11-6.5-0.229 | 5052-H32 | 6.5 | 4.96 | 0.229 | 3" x 5" Reinforced (MIN 14" AG) | 64 |
| 12 | RF-A-12-5.75-0.091 | 5052-H32 | 5.75 | 4.07 | 0.091 | 3" x 5" Reinforced (MIN 9" AG) | 27 |
| | RF-A-12-5.75-0.144 | 5052-H32 | 5.75 | 4.07 | 0.144 | 3" x 5" Reinforced (MIN 9" AG) | 41 |
| | RF-A-12-5.75-0.182 | 5052-H32 | 5.75 | 4.07 | 0.182 | 3" x 5" Reinforced (MIN 9" AG) | 49 |
| | RF-A-12-5.75-0.229 | 5052-H32 | 5.75 | 4.07 | 0.229 | 3" x 5" Reinforced (MIN 9" AG) | 58 |
| | RF-A-12-6.5-0.091 | 5052-H32 | 6.5 | 4.82 | 0.091 | 3" x 5" Reinforced (MIN 14" AG) | 34 |
| | RF-A-12-6.5-0.144 | 5052-H32 | 6.5 | 4.82 | 0.144 | 3" x 5" Reinforced (MIN 14" AG) | 47 |
| | RF-A-12-6.5-0.182 | 5052-H32 | 6.5 | 4.82 | 0.182 | 3" x 5" Reinforced (MIN 14" AG) | 57 |
| | RF-A-12-6.5-0.229 | 5052-H32 | 6.5 | 4.82 | 0.229 | 3" x 5" Reinforced (MIN 14" AG) | 68 |
| 13 | RF-A-13-6.5-0.091 | 5052-H32 | 6.5 | 4.68 | 0.091 | 3" x 5" Reinforced (MIN 14" AG) | 36 |
| | RF-A-13-6.5-0.144 | 5052-H32 | 6.5 | 4.68 | 0.144 | 3" x 5" Reinforced (MIN 14" AG) | 50 |
| | RF-A-13-6.5-0.182 | 5052-H32 | 6.5 | 4.68 | 0.182 | 3" x 5" Reinforced (MIN 14" AG) | 60 |
| | RF-A-13-6.5-0.229 | 5052-H32 | 6.5 | 4.68 | 0.229 | 3" x 5" Reinforced (MIN 14" AG) | 72 |
| 14 | RF-A-14-6.5-0.091 | 5052-H32 | 6.5 | 4.54 | 0.091 | 3" x 5" Reinforced (MIN 14" AG) | 37 |
| | RF-A-14-6.5-0.144 | 5052-H32 | 6.5 | 4.54 | 0.144 | 3" x 5" Reinforced (MIN 14" AG) | 52 |
| | RF-A-14-6.5-0.182 | 5052-H32 | 6.5 | 4.54 | 0.182 | 3" x 5" Reinforced (MIN 14" AG) | 63 |
| | RF-A-14-6.5-0.229 | 5052-H32 | 6.5 | 4.54 | 0.229 | 3" x 5" Reinforced (MIN 14" AG) | 75 |
| | RF-A-14-7-0.091 | 5052-H32 | 7 | 5.04 | 0.091 | 3" x 5" Reinforced (MIN 14" AG) | 40 |
| | RF-A-14-7-0.144 | 5052-H32 | 7 | 5.04 | 0.144 | 3" x 5" Reinforced (MIN 14" AG) | 56 |
| | RF-A-14-7-0.182 | 5052-H32 | 7 | 5.04 | 0.182 | 3" x 5" Reinforced (MIN 14" AG) | 67 |
| | RF-A-14-7-0.229 | 5052-H32 | 7 | 5.04 | 0.229 | 3" x 5" Reinforced (MIN 14" AG) | 81 |
| 15 | RF-A-15-6.5-0.091 | 5052-H32 | 6.5 | 4.4 | 0.091 | 3" x 5" Reinforced (MIN 14" AG) | 39 |
| | RF-A-15-6.5-0.144 | 5052-H32 | 6.5 | 4.4 | 0.144 | 3" x 5" Reinforced (MIN 14" AG) | 55 |
| | RF-A-15-6.5-0.182 | 5052-H32 | 6.5 | 4.4 | 0.182 | 3" x 5" Reinforced (MIN 14" AG) | 66 |
| | RF-A-15-6.5-0.229 | 5052-H32 | 6.5 | 4.4 | 0.229 | 3" x 5" Reinforced (MIN 14" AG) | 79 |
| | RF-A-15-7-0.091 | 5052-H32 | 7 | 4.9 | 0.091 | 3" x 5" Reinforced (MIN 14" AG) | 42 |
| | RF-A-15-7-0.144 | 5052-H32 | 7 | 4.9 | 0.144 | 3" x 5" Reinforced (MIN 14" AG) | 59 |
| | RF-A-15-7-0.182 | 5052-H32 | 7 | 4.9 | 0.182 | 3" x 5" Reinforced (MIN 14" AG) | 71 |
| | RF-A-15-7-0.229 | 5052-H32 | 7 | 4.9 | 0.229 | 3" x 5" Reinforced (MIN 14" AG) | 85 |

RF-A PEDESTRIAN METAL POLE

RF ALUMINUM // Pole Details

| Nominal Mounting Height (ft) | Catalog Code | Alloy | Butt (in) | Tip (in) | Wall Thickness (in) | Handhole | Wt. (lbs) * |
|------------------------------|-------------------|----------|-----------|----------|---------------------|---------------------------------|-------------|
| 16 | RF-A-16-6.5-0.144 | 5052-H32 | 6.5 | 4.26 | 0.144 | 3" x 5" Reinforced (MIN 14" AG) | 57.0 |
| | RF-A-16-6.5-0.182 | 5052-H32 | 6.5 | 4.26 | 0.182 | 3" x 5" Reinforced (MIN 14" AG) | 68.0 |
| | RF-A-16-6.5-0.229 | 5052-H32 | 6.5 | 4.26 | 0.229 | 3" x 5" Reinforced (MIN 14" AG) | 83.0 |
| | RF-A-16-7-0.091 | 5052-H32 | 7 | 4.76 | 0.091 | 3" x 5" Reinforced (MIN 14" AG) | 43.0 |
| | RF-A-16-7-0.144 | 5052-H32 | 7 | 4.76 | 0.144 | 3" x 5" Reinforced (MIN 14" AG) | 61.0 |
| | RF-A-16-7-0.182 | 5052-H32 | 7 | 4.76 | 0.182 | 3" x 5" Reinforced (MIN 14" AG) | 74.0 |
| | RF-A-16-7-0.229 | 5052-H32 | 7 | 4.76 | 0.229 | 3" x 5" Reinforced (MIN 14" AG) | 89.0 |
| 17 | RF-A-17-6.5-0.144 | 5052-H32 | 6.5 | 4.12 | 0.144 | 3" x 5" Reinforced (MIN 14" AG) | 59.0 |
| | RF-A-17-6.5-0.182 | 5052-H32 | 6.5 | 4.12 | 0.182 | 3" x 5" Reinforced (MIN 14" AG) | 71.0 |
| | RF-A-17-6.5-0.229 | 5052-H32 | 6.5 | 4.12 | 0.229 | 3" x 5" Reinforced (MIN 14" AG) | 86.0 |
| | RF-A-17-7-0.144 | 5052-H32 | 7 | 4.62 | 0.144 | 3" x 5" Reinforced (MIN 14" AG) | 64.0 |
| | RF-A-17-7-0.182 | 5052-H32 | 7 | 4.62 | 0.182 | 3" x 5" Reinforced (MIN 14" AG) | 77.0 |
| | RF-A-17-7-0.229 | 5052-H32 | 7 | 4.62 | 0.229 | 3" x 5" Reinforced (MIN 14" AG) | 93.0 |
| 18 | RF-A-18-7-0.144 | 5052-H32 | 7 | 4.48 | 0.144 | 3" x 5" Reinforced (MIN 14" AG) | 66.0 |
| | RF-A-18-7-0.182 | 5052-H32 | 7 | 4.48 | 0.182 | 3" x 5" Reinforced (MIN 14" AG) | 80.0 |
| | RF-A-18-7-0.229 | 5052-H32 | 7 | 4.48 | 0.229 | 3" x 5" Reinforced (MIN 14" AG) | 97.0 |

* Weight includes the pole shaft and baseplate.

SHAFT LOADING

RF ALUMINUM // Loading

| Nominal Mounting Height (ft) | Catalog Code | Design Information // AASHTO LTS-6, 2013 ** | | | | | | | | | |
|------------------------------|--------------------|---|----------------|-----------------|----------------|-----------------|----------------|-----------------|----------------|-----------------|----------------|
| | | 90 MPH | | 100 MPH | | 110 MPH | | 120 MPH | | 150 MPH | |
| | | Max EPA (sq ft) | Max Load (lbs) | Max EPA (sq ft) | Max Load (lbs) | Max EPA (sq ft) | Max Load (lbs) | Max EPA (sq ft) | Max Load (lbs) | Max EPA (sq ft) | Max Load (lbs) |
| 10 | RF-A-10-5.75-0.091 | 5.6 | 200 | 4.2 | 200 | 3.3 | 200 | 2.7 | 200 | 1.5 | 200 |
| | RF-A-10-5.75-0.144 | 9.0 | 200 | 7.0 | 200 | 5.7 | 200 | 4.6 | 200 | 2.8 | 200 |
| | RF-A-10-5.75-0.182 | 10.1 | 300 | 8.0 | 200 | 6.5 | 200 | 5.3 | 200 | 3.2 | 200 |
| | RF-A-10-5.75-0.229 | 11.6 | 300 | 9.2 | 200 | 7.4 | 200 | 6.2 | 200 | 3.8 | 200 |
| | RF-A-10-6.5-0.091 | 7.8 | 200 | 6.2 | 200 | 5.0 | 200 | 4.1 | 200 | 2.4 | 200 |
| | RF-A-10-6.5-0.144 | 12.8 | 300 | 10.3 | 300 | 8.5 | 200 | 7.0 | 200 | 4.3 | 200 |
| | RF-A-10-6.5-0.182 | 14.7 | 300 | 11.8 | 300 | 9.7 | 200 | 8.0 | 200 | 5.0 | 200 |
| | RF-A-10-6.5-0.229 | 16.8 | 300 | 13.5 | 300 | 11.0 | 300 | 9.2 | 200 | 5.7 | 200 |
| 11 | RF-A-11-5.75-0.091 | 4.7 | 200 | 3.4 | 200 | 2.6 | 200 | 2.1 | 200 | 1.1 | 200 |
| | RF-A-11-5.75-0.144 | 7.8 | 200 | 5.9 | 200 | 4.7 | 200 | 3.8 | 200 | 2.2 | 200 |
| | RF-A-11-5.75-0.182 | 8.9 | 200 | 6.8 | 200 | 5.4 | 200 | 4.4 | 200 | 2.6 | 200 |
| | RF-A-11-5.75-0.229 | 10.0 | 300 | 7.9 | 200 | 6.3 | 200 | 5.2 | 200 | 3.1 | 200 |
| | RF-A-11-6.5-0.091 | 6.6 | 200 | 5.2 | 200 | 4.1 | 200 | 3.4 | 200 | 1.9 | 200 |
| | RF-A-11-6.5-0.144 | 11.1 | 300 | 8.9 | 200 | 7.2 | 200 | 6.0 | 200 | 3.6 | 200 |
| | RF-A-11-6.5-0.182 | 12.7 | 300 | 10.2 | 300 | 8.4 | 200 | 6.9 | 200 | 4.2 | 200 |
| | RF-A-11-6.5-0.229 | 14.7 | 300 | 11.7 | 300 | 9.7 | 200 | 8.0 | 200 | 4.9 | 200 |
| 12 | RF-A-12-5.75-0.091 | 3.9 | 200 | 2.7 | 200 | 2.0 | 200 | 1.5 | 200 | 0.7 | 200 |
| | RF-A-12-5.75-0.144 | 6.6 | 200 | 5.0 | 200 | 3.9 | 200 | 3.1 | 200 | 1.8 | 200 |
| | RF-A-12-5.75-0.182 | 7.7 | 200 | 5.8 | 200 | 4.6 | 200 | 3.7 | 200 | 2.1 | 200 |
| | RF-A-12-5.75-0.229 | 8.9 | 200 | 6.8 | 200 | 5.4 | 200 | 4.4 | 200 | 2.6 | 200 |
| | RF-A-12-6.5-0.091 | 5.6 | 200 | 4.3 | 200 | 3.4 | 200 | 2.7 | 200 | 1.5 | 200 |
| | RF-A-12-6.5-0.144 | 9.7 | 200 | 7.7 | 200 | 6.2 | 200 | 5.1 | 200 | 3.1 | 200 |
| | RF-A-12-6.5-0.182 | 11.1 | 300 | 8.9 | 200 | 7.2 | 200 | 5.9 | 200 | 3.6 | 200 |
| | RF-A-12-6.5-0.229 | 12.8 | 300 | 10.2 | 300 | 8.4 | 200 | 6.9 | 200 | 4.2 | 200 |

RF-A PEDESTRIAN METAL POLE

RF ALUMINUM // Loading

| Nominal Mounting Height (ft) | Catalog Code | Design Information // AASHTO LTS-6, 2013 ** | | | | | | | | | |
|------------------------------|-------------------|---|----------------|-----------------|----------------|-----------------|----------------|-----------------|----------------|-----------------|----------------|
| | | 90 MPH | | 100 MPH | | 110 MPH | | 120 MPH | | 150 MPH | |
| | | Max EPA (sq ft) | Max Load (lbs) | Max EPA (sq ft) | Max Load (lbs) | Max EPA (sq ft) | Max Load (lbs) | Max EPA (sq ft) | Max Load (lbs) | Max EPA (sq ft) | Max Load (lbs) |
| 13 | RF-A-13-6.5-0.091 | 4.7 | 200 | 3.5 | 200 | 2.7 | 200 | 2.2 | 200 | 1.1 | 200 |
| | RF-A-13-6.5-0.144 | 8.4 | 200 | 6.6 | 200 | 5.3 | 200 | 4.3 | 200 | 2.5 | 200 |
| | RF-A-13-6.5-0.182 | 9.8 | 200 | 7.7 | 200 | 6.2 | 200 | 5.1 | 200 | 3.0 | 200 |
| | RF-A-13-6.5-0.229 | 11.3 | 300 | 9.0 | 200 | 7.3 | 200 | 6.0 | 200 | 3.6 | 200 |
| 14 | RF-A-14-6.5-0.091 | 3.9 | 200 | 2.8 | 200 | 2.2 | 200 | 1.7 | 200 | 0.8 | 200 |
| | RF-A-14-6.5-0.144 | 7.3 | 200 | 5.6 | 200 | 4.5 | 200 | 3.6 | 200 | 2.1 | 200 |
| | RF-A-14-6.5-0.182 | 8.6 | 200 | 6.7 | 200 | 5.3 | 200 | 4.3 | 200 | 2.5 | 200 |
| | RF-A-14-6.5-0.229 | 10.0 | 300 | 7.9 | 200 | 6.3 | 200 | 5.2 | 200 | 3.1 | 200 |
| | RF-A-14-7-0.091 | 5.1 | 200 | 3.9 | 200 | 3.1 | 200 | 2.4 | 200 | 1.3 | 200 |
| | RF-A-14-7-0.144 | 9.2 | 200 | 7.2 | 200 | 5.8 | 200 | 4.8 | 200 | 2.8 | 200 |
| | RF-A-14-7-0.182 | 10.6 | 300 | 8.6 | 200 | 6.9 | 200 | 5.7 | 200 | 3.4 | 200 |
| | RF-A-14-7-0.229 | 12.5 | 300 | 9.9 | 200 | 8.1 | 200 | 6.6 | 200 | 4.0 | 200 |
| 15 | RF-A-15-6.5-0.091 | 3.2 | 200 | 2.2 | 200 | 1.6 | 200 | 1.2 | 200 | 0.5 | 200 |
| | RF-A-15-6.5-0.144 | 6.4 | 200 | 4.8 | 200 | 3.7 | 200 | 3.0 | 200 | 1.7 | 200 |
| | RF-A-15-6.5-0.182 | 7.6 | 200 | 5.7 | 200 | 4.5 | 200 | 3.7 | 200 | 2.1 | 200 |
| | RF-A-15-6.5-0.229 | 8.9 | 200 | 6.9 | 200 | 5.5 | 200 | 4.5 | 200 | 2.6 | 200 |
| | RF-A-15-7-0.091 | 4.3 | 200 | 3.2 | 200 | 2.5 | 200 | 1.9 | 200 | 0.9 | 200 |
| | RF-A-15-7-0.144 | 8.0 | 200 | 6.3 | 200 | 5.0 | 200 | 4.1 | 200 | 2.3 | 200 |
| | RF-A-15-7-0.182 | 9.6 | 200 | 7.5 | 200 | 6.0 | 200 | 4.9 | 200 | 2.9 | 200 |
| | RF-A-15-7-0.229 | 11.1 | 300 | 8.9 | 200 | 7.1 | 200 | 5.8 | 200 | 3.4 | 200 |
| 16 | RF-A-16-6.5-0.144 | 5.5 | 200 | 4.0 | 200 | 3.1 | 200 | 2.4 | 200 | 1.3 | 200 |
| | RF-A-16-6.5-0.182 | 6.6 | 200 | 4.9 | 200 | 3.8 | 200 | 3.1 | 200 | 1.7 | 200 |
| | RF-A-16-6.5-0.229 | 7.9 | 200 | 6.0 | 200 | 4.7 | 200 | 3.8 | 200 | 2.1 | 200 |
| | RF-A-16-7-0.091 | 3.5 | 200 | 2.5 | 200 | 1.9 | 200 | 1.4 | 200 | 0.6 | 200 |
| | RF-A-16-7-0.144 | 7.0 | 200 | 5.4 | 200 | 4.3 | 200 | 3.5 | 200 | 1.9 | 200 |
| | RF-A-16-7-0.182 | 8.4 | 200 | 6.6 | 200 | 5.2 | 200 | 4.2 | 200 | 2.4 | 200 |
| | RF-A-16-7-0.229 | 10.0 | 300 | 7.9 | 200 | 6.3 | 200 | 5.1 | 200 | 3.0 | 200 |
| | 17 | RF-A-17-6.5-0.144 | 4.7 | 200 | 3.3 | 200 | 2.4 | 200 | 1.9 | 200 | 0.9 |
| RF-A-17-6.5-0.182 | | 5.7 | 200 | 4.2 | 200 | 3.1 | 200 | 2.5 | 200 | 1.3 | 200 |
| RF-A-17-6.5-0.229 | | 6.9 | 200 | 5.1 | 200 | 3.9 | 200 | 3.2 | 200 | 1.7 | 200 |
| RF-A-17-7-0.144 | | 6.0 | 200 | 4.6 | 200 | 3.6 | 200 | 2.8 | 200 | 1.5 | 200 |
| RF-A-17-7-0.182 | | 7.4 | 200 | 5.6 | 200 | 4.4 | 200 | 3.6 | 200 | 2.0 | 200 |
| RF-A-17-7-0.229 | | 8.8 | 200 | 6.8 | 200 | 5.5 | 200 | 4.4 | 200 | 2.5 | 200 |
| 18 | RF-A-18-7-0.144 | 5.2 | 200 | 3.8 | 200 | 2.9 | 200 | 2.3 | 200 | 1.1 | 200 |
| | RF-A-18-7-0.182 | 6.4 | 200 | 4.8 | 200 | 3.7 | 200 | 3.0 | 200 | 1.6 | 200 |
| | RF-A-18-7-0.229 | 7.8 | 200 | 5.9 | 200 | 4.7 | 200 | 3.8 | 200 | 2.1 | 200 |

** EPA represents the Effective Projected Area of the attachments on the pole. Designs are limited to post top luminaires or attachments located at or below the mounting height. Consult factory for poles supporting attachments located above the mounting height.

BASE COMPATIBILITY

RF-A PEDESTRIAN METAL POLE

| Pole Butt Size | Split Bases | | | | | | | |
|----------------|-------------|-------|-------|-------|-------|-------|-------|-------|
| | KSB10 | KSB52 | KSB16 | KSB19 | KSB70 | KSB77 | KSB76 | KSB20 |
| 5.75 | | | | | | | | |
| 6.5 | | | | | | | | |
| 7 | | | | | | | | |